

## Warranty

The manufacturer warrants batteries to be free from defects in materials and workmanship for a period of one year from the date of shipment. Batteries will be replaced at no charge during this warranty period. Product must be returned prepaid along with proof of purchase.

The manufacturer makes no warranties, expressed or implied, of merchantability, fitness for a particular purpose, performance, condition, capacity or otherwise. The manufacturer is not liable for incidental or consequential damages, monetary loss, loss of sales or loss of business resulting from the failure or malfunction of the product.

Warranty is void on any product that is misused, misapplied, abused, altered, repaired by unauthorized personnel, or where evidence of tampering exists. The foregoing constitutes the sole and exclusive remedy of the purchaser and is in lieu of all other warranties. No greater degree of liability is imposed on the manufacturer.

The facilities listed below are equipped to handle the return of used batteries from POWERVAR's Uninterruptible Power Manager. Used batteries should be repackaged in the same packaging in which the new replacement batteries arrived. The old batteries should then be returned to one of the facilities at the addresses shown.

POWERVAR, Inc.  
1450 Lakeside Drive, Waukegan, IL 60085  
Phone: (847) 596-7000  
Toll Free: (800) 369-7179 (outside Illinois only)  
Fax: (847) 596-7100

POWERVAR, Ltd.  
Unit 5 Birch, Kembrey Park  
Swindon, Wiltshire SN2 8UU  
United Kingdom  
Phone: +44 (0) 1793-553980  
Fax: +44 (0) 1793-535350

# Security One UPM User Replaceable Battery

## Handling and Replacement Procedures





Changing the batteries in this UPM is designed to be a safe and simple procedure. Batteries may be replaced while the UPM is on and providing power to the connected load. You should remember, however, that if a power outage occurs after the old batteries are disconnected and before the new batteries are installed, power will be lost to your connected system and components. Servicing of batteries should always be performed or supervised by someone who has read and understood the following precautions and who understands the hazards associated with storage batteries. This procedure should not be performed by someone who is unauthorized or who is incapable of following these precautions.

- ☞ Only the battery assembly in this unit is user serviceable. The battery compartment is accessed by removing the front panel as described in the following instructions. No other user serviceable parts are contained in this UPM. Do not remove any cover other than the front battery access panels.
- ☞ A battery (even a depleted one) can deliver very high currents when short-circuited. There is a danger of electrical shock. Remove all watches, rings, bracelets or other metal objects. Use only tools with insulated handles.
- ☞ Do not dispose of batteries in a fire. There is a danger of explosion. Do not dispose of batteries in an environmentally unfriendly manner. Batteries may be returned to POWERVAR for proper disposal. **A UPS ARS (automatic return service) label is included with your new batteries. Complete the label, place the old batteries in the packaging in which the new batteries arrived, secure the shipping carton and place the ARS shipping label on the outside of the shipping carton. Deliver the carton to any UPS driver or UPS depot for no cost return.**
- ☞ Do not open or mutilate the batteries. This may release electrolyte that is toxic to the environment and harmful to the skin and eyes.

If you have read and understood the cautions preceding this section, you may proceed with the following steps. Consult Figure 1 to assist you in the following battery replacement procedure.

### **Battery Replacement**

1. Remove the two small screws from the bottom of the front panel that secure the front panel to the frame of the UPM.
2. Carefully slide the front panel off the UPM taking care not to damage or tear the ribbon cable that connects the front panel "dashboard" display to the UPM.
3. Remove the screw(s) that secures the battery assembly retaining bracket, remove it from the unit, and set it to one side.
4. Slide the battery pack from the UPM by pulling on the tab provided.
5. Disconnect the battery from the UPM by pulling apart the wire leads at the connector provided.
6. Connect the new battery pack to the UPM by reconnecting the connector making sure to observe proper polarity (i.e. black to black and red to red).
7. Push the new battery pack into place.
8. Replace the battery-retaining bracket removed in step 3 and replace the screw(s) that secures it in place.

9. Slide the front panel (removed in step 2) back on the front of the UPM taking care not to pinch or damage the ribbon cable.
10. Replace the front cover screws and tighten.

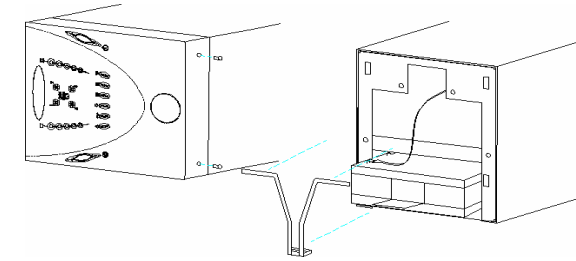

Older 350 - 800 VA Models

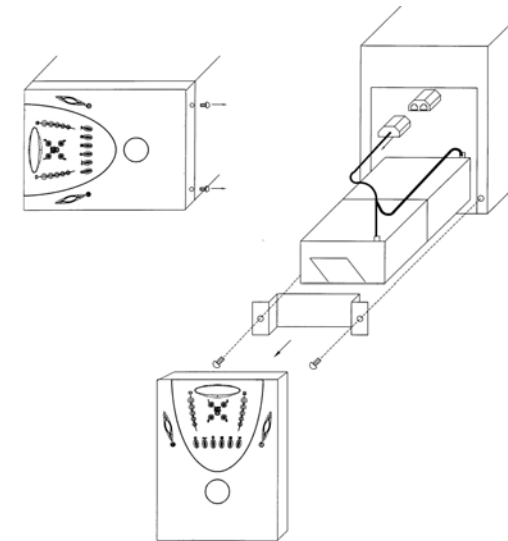

Newer 350-800 VA Models  
All 1100 and 1440 VA models

**Figure 1 – Battery Removal/Replacement**

For rackmount versions of the Uninterruptible Power Manager, follow these steps. Please reference Figure 2 to assist you in the battery replacement procedure.

#### Battery Replacement for Rackmount UPM

1. The left hand side of the faceplate is removable. Insert fingers into the slot of the faceplate and pull toward you. The faceplate will pop off.
2. Behind the removable faceplate is a metal access panel held in place by a knurled thumbscrew. Turn the knurled thumbscrew counterclockwise until it is completely free.
3. Open the metal access plate revealing the battery pack.
4. Slide the battery pack from the UPM by pulling on the tab provided.
5. Disconnect the battery from the UPM by pulling apart the wire leads at the connector provided.
6. Connect the new battery pack to the UPM by reconnecting the connector making sure to observe proper polarity (i.e. black to black and red to red).
7. Push the new battery pack into place.
8. Close the metal access plate and turn the knurled thumbscrew clockwise until it is tight.
9. Replace the removable front panel by pressing it back into position until it is securely attached to the front of the UPM.

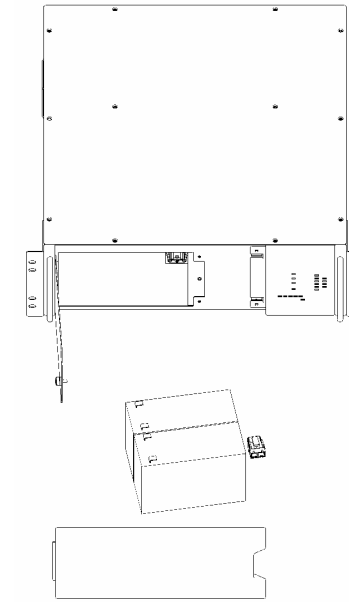

600 and 800 VA Models

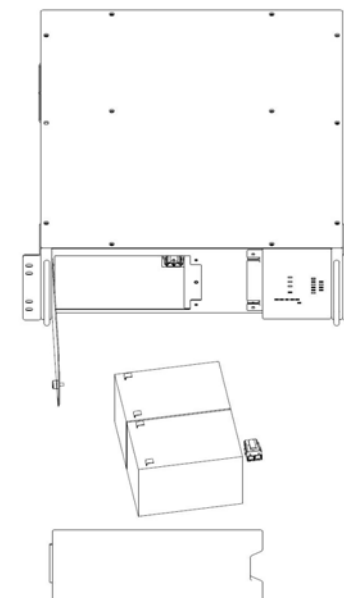

1100 VA models

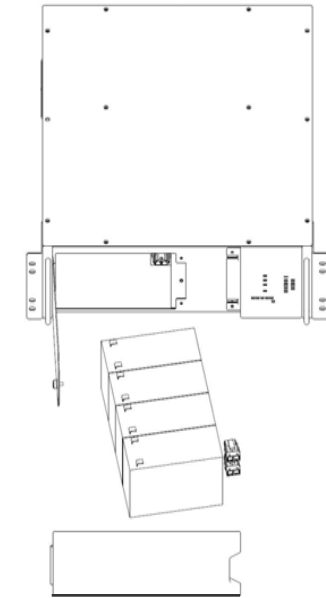

1440 VA models

**Figure 2 – Battery  
Removal/Replacement**